

# Box Tray System <sup>(BTS)</sup>

Writanium® Porcelain Markerboards, Chalkboards, & Tackboards

## INSTALLATION INSTRUCTIONS

### NOTES:

1. Adhesive is recommended behind all tackboards.
2. Backing must be located for successful installation.
3. Fastener type shall be determined by wall condition.
4. Contact manufacturer for fastener recommendation.

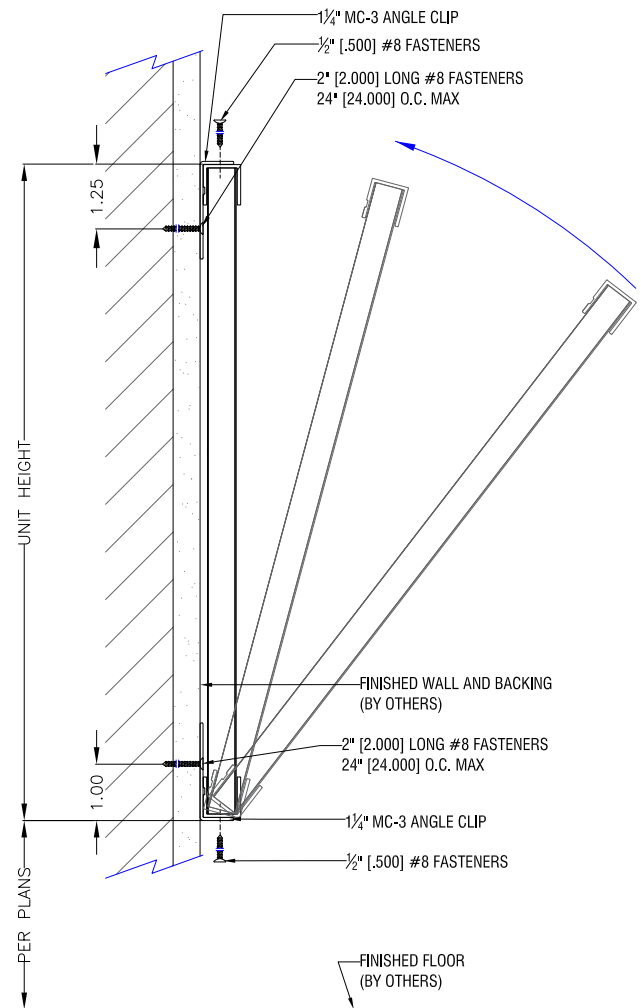
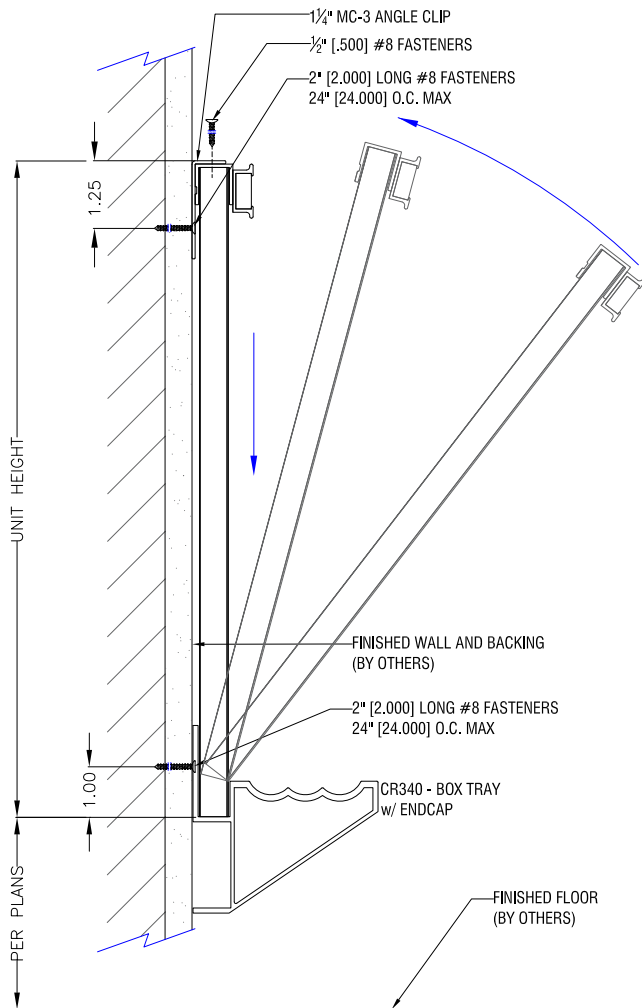

# Box Tray System <sup>(BTS)</sup>

Writanium® Porcelain Markerboards, Chalkboards, & Tackboards

## INSTALLATION INSTRUCTIONS

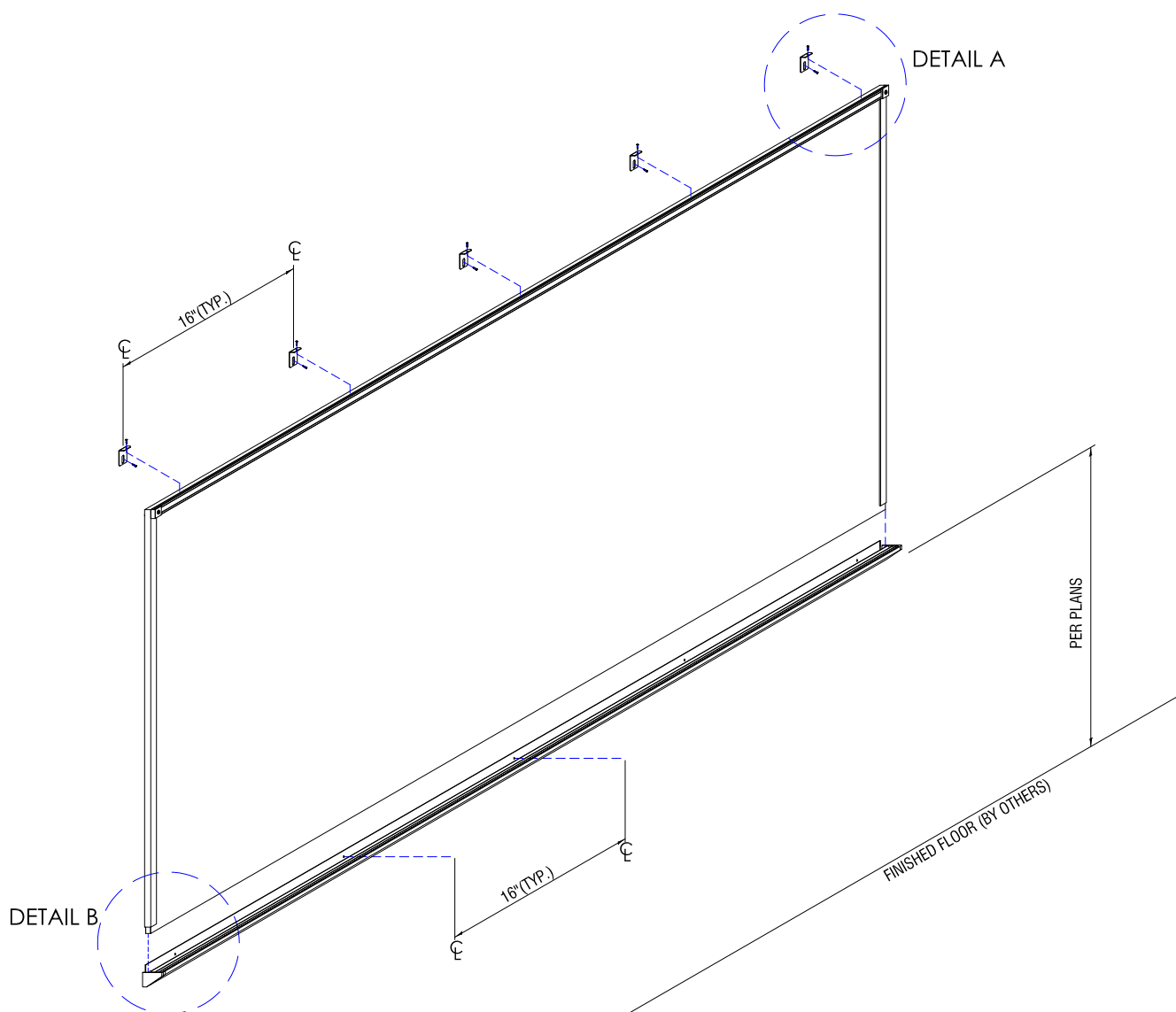

# Box Tray System <sup>(BTS)</sup>

Writanium® Porcelain Markerboards, Chalkboards, & Tackboards

## INSTALLATION INSTRUCTIONS

