

Display Cases: Trophy and Display Case with Sliding Glass Doors [sws]



For Wall Mounted Trophy Cases with Sliding Glass Doors

- These attractive display and Trophy Cases have repositionable shelving that will accommodate any accolade.
- Sliding doors are made of 1/4" tempered glass.
- Wood box features birch veneer or a variety of HPL finishes.
- Optional base and upper cornice available.

Suggested Specifications

PART 1: *general*

1.1 SECTION INCLUDES

- A. Vinyl Cork Tackboard Trophy Case.

1.2 RELATED SECTIONS

- A. Section 06100 – Wood or Steel Blocking.
- B. Section 09000 – Gypsum Wall Board.
- C. Section 09720 – Vinyl Wall Coverings.
- D. Section 09900 – Paints and Coatings.

1.3 REFERENCES

- A. ASTM B221 – Standard Specification for Aluminum and Aluminum-Alloy Extruded Bars, Rods, Wire, Shapes, and Tubes.
- B. ASTM E84 – Test Method for Surface Burning and Characteristics of Building Materials.

1.4 SUBMITTALS

- A. Submit products and samples under provisions of Section 01300.
- B. Product Data: Provide technical data for products specified. Include Material Safety Data Sheets, when applicable.
- C. Shop Drawings: Provide shop drawings for each type of visual display board specified including section details indicating trim, face, core and backing materials, dimensions, joint locations and special anchor details.
- D. Color Samples: Submit set of color chips displaying manufacturer's full range of colors and finishes.
- E. Product Samples: Submit samples not less than twelve inches square and framed on two adjacent sides, to illustrate materials, finish, color, and configuration of each type of visual display board required.
- F. Care and Maintenance Data: Provide data on cleaning requirements, stain removal, and recommended maintenance precautions.

1.5 DELIVERY, STORAGE AND HANDLING

- A. Comply with manufacturer's instructions for handling and storage of Trophy Cases.

1.6 PROJECT CONDITIONS

- A. Field measure prior to fabrication to ensure proper fit.
- B. General contractor to maintain proper climate before, during and after installation.

1.7 WARRANTY

- A. Submit manufacturer's "One Year" warranty, stating that under normal usage and maintenance, and when installed in accordance with manufacturer's instructions and recommendations, Trophy Cases are warranted for one year.
- B. Warranty shall cover replacement of defective workmanship and product defects. Warranty does not cover the cost of removal or reinstallation.

PART 2: *products*

2.1 MANUFACTURERS

- A. Provide visual display boards as manufactured by Platinum Visual Systems™, Corona, California. Tel.: (800)498-2990 Fax: (951)817-9900. Email: info@pvsusa.com. Website: www.pvsusa.com.
- B. Substitutions: See Section 01600 – Product Requirements.

2.2 BULLETIN AND DIRECTORY CASE MATERIALS

- A. Vinyl Face Sheets: Vinyl surface will be Type II self-healing, weighing not less than 21 ounces per lineal yard. Pattern to be a Harborweave.
 - 1. Vinyl shall be washable and mildew resistant.
- B. Core Material: 1/4" natural cork.
- C. Wood Box Material: 3/4" plywood with Birch veneer.
- D. Metal Trim: 6063 aluminum alloy with a T5 temper.
- E. Glass: 1/4" tempered glass.
- F. Adhesive: As recommended by manufacturer for project conditions.

2.3 TROPHY CASE WITH SLIDING GLASS DOORS

- A. Provide Trophy Cases with Sliding Glass Doors for project from manufacturer's SWS Series.
 - 1. Metal trim and accessories: SWS Series thick wall aluminum extrusions with clear satin anodized finish.
 - a. Housing TU220: One piece aluminum 2" x 2" tube perimeter housing.
 - b. Door Frame CH200: Channel frame with plastic seal at glass. Channel to have integrated wheels.
 - c. Top Door Track TT760: One piece aluminum channel with plastic guides at top of glass.
 - d. Bottom Door Track BT660: One piece aluminum channel with roller guide.
 - e. Lock: Sliding ratchet lock.
 - 2. Back Panel: Vinyl cork tackboard standard.
 - 3. Glass Doors and Shelves: 1/4" tempered glass.
 - a. Doors: 4', 5' and 6' widths to have two doors, 8' and 10' widths to have three doors, 12' width to have four doors and 16' width to have five doors. Doors shall have pencil edge finish.
 - b. Shelves: Two 6", 8", 10" or 12" deep rows of glass shelves with pencil edge finish and brackets with adjustable standards.
 - 4. Glass Side Lights: 1/4" tempered glass.
 - 5. Wood Box: 3/4" plywood with Birch veneer with clear natural finish. Depth to be 12", 16" or 24". Optional finishes available.
 - 6. Size: 4' high x 4', 5', 6', 8', 10', 12', or 16' wide x 12", 16" or 24" deep.
 - 7. Color: As selected from manufacturer's standard colors.
 - 8. Optional: Base and Upper Cornice.

2.4 FABRICATION

- A. Laminate facing sheet and backing sheet to core material under pressure, using manufacturer's recommended adhesive.
- B. Provide factory-assembled visual display boards, except where sizes demand partial field assembly.

PART 3: *execution*

3.1 EXAMINATION

- A. Verify that substrates are properly prepared to receive Trophy Cases. Do not begin installation until unsatisfactory conditions have been corrected.

3.2 INSTALLATION

- A. Comply with manufacturer's installation instructions.
- B. Install visual display boards level and plumb, keeping perimeter trim aligned in accordance with manufacturer's recommendations.

3.3 ADJUSTING AND CLEANING

- A. Verify that all accessories are installed as required for each unit.
- B. Upon completion of installation, clean surfaces and trim in accordance with manufacturer's recommendations, leaving all materials ready for use.

SWS: Specifications

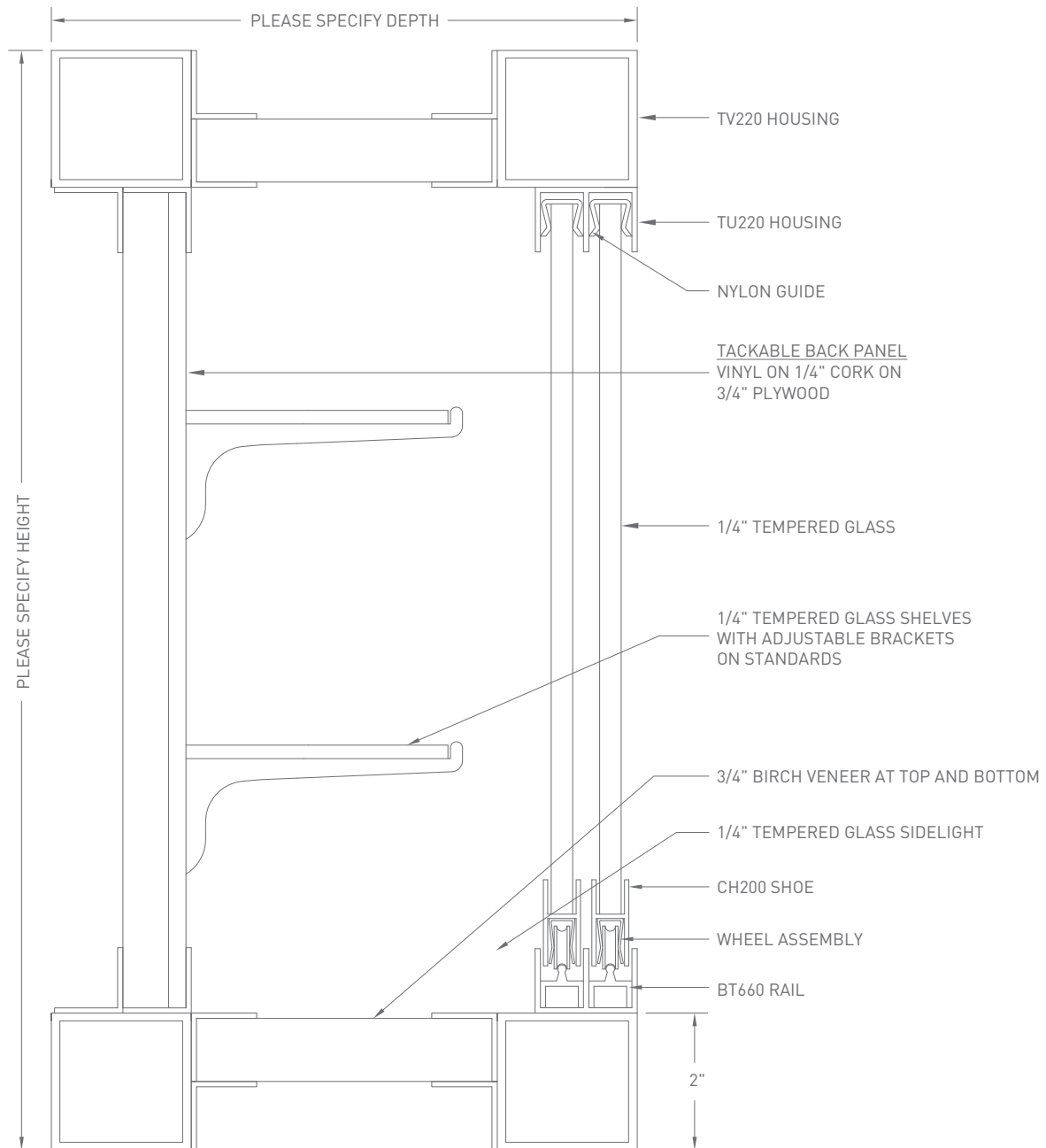

PLATINUM
LET'S CREATE TOGETHER.™

1451 E. Sixth Street, Corona, CA 92879
800 498 2990 | 951 817 2200 | FAX 951 817 9900
www.pvsusa.com | info@pvsusa.com